

SketchUp LayOut

Training course outline

Provided with SketchUp Pro, the LayOut tool is used to create professional design documents, dimensioned drawings and presentations from your 3D models.

SketchUp LayOut training teaches everything you need to present your SketchUp models effectively in 2D.

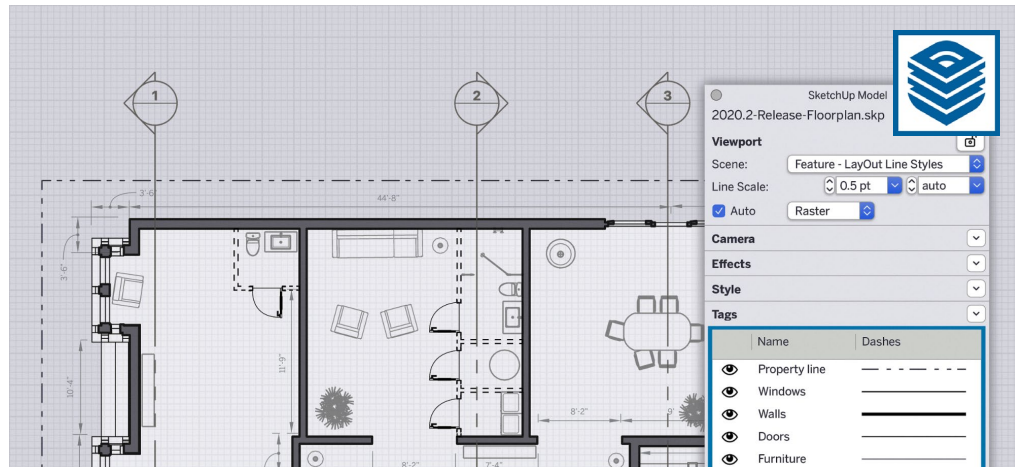

Course summary

Teaches how to create 2D drawings and plans, and incorporate your SketchUp 3D models into 2D layouts. Sessions include:

- Preparing your model in SketchUp Pro for LayOut.
- Creating 2D designs from your 3D models.
- Drafting accurately in 2D.
- Adding title blocks, annotations, callouts and dimensions.
- Printing to scale and export for digital distribution.

Duration

One day.

Who should attend?

This course is aimed at new users of SketchUp Pro running on a Windows or Mac computer.

Delegates should have good computing skills. No prior CAD knowledge is necessary.

In-class or live online

You can attend course in-person at any of our centres, or participate online from your place of work or home.

To read about our approach to online training, see armada.co.uk/live-online-training.

General information

SketchUp LayOut courses are hosted by industry experts, who have been providing CAD training for over 20 years.

Whilst attending training at our centres, delegates have the use of a computer running SketchUp on which to practice the techniques taught.

Course fees can be paid by card or bank transfer. We accept purchase orders from UK-registered companies and public sector organisations.

If you're self-funding your training, you can pay in staged payments, interest-free, over 12 months.

Method of delivery

Training is designed for the busy professional, being short and intensive and combining lecture and demonstration. Practical exercises carried out under guidance help delegates to learn the techniques taught.

Delegates have ample opportunity to discuss their specific requirements.

Course materials and certificate

Delegates receive:

- A comprehensive training guide.
- An e-certificate confirming successful completion of a *SketchUp LayOut* course.

After course support

Following SketchUp training, you're entitled to 30 days' email support from your trainer

Further information

For further details, see armada.co.uk/course/sketchuplayout.

Course syllabus

See over.

Course syllabus

| | | | |
|--|---|---|---|
| Introduction to LayOut | The SketchUp to LayOut workflow Navigating the LayOut 2D environment | SketchUp and LayOut dynamic link | |
| Preparing your model in SketchUp Pro for LayOut | Planning Groups and components SketchUp layers | Organising in LayOut | Tags Grid |
| SketchUp scenes for LayOut | Creating scenes for LayOut Section cuts Clipping planes Fog | Title blocks | Title block border Project information area text |
| SketchUp styles | Customising styles | Annotation | Labels Symbols and annotations Creating and aligning objects Creating groups |
| LayOut Orientation | New document Selecting /moving objects Model space | Scrapbooks | |
| SketchUp Viewports | Preset viewport perspectives Changing the style of your viewport Viewport render settings Background and Z-order | | |