

Advance Steel Essentials

Training course outline

Autodesk Advance Steel is used to create and detail 3D steel structures.

Advance Steel makes it easy to create common connections and elements such as stairs, railings and ladders, and extract drawings, Bills of materials and schedules for your designs.

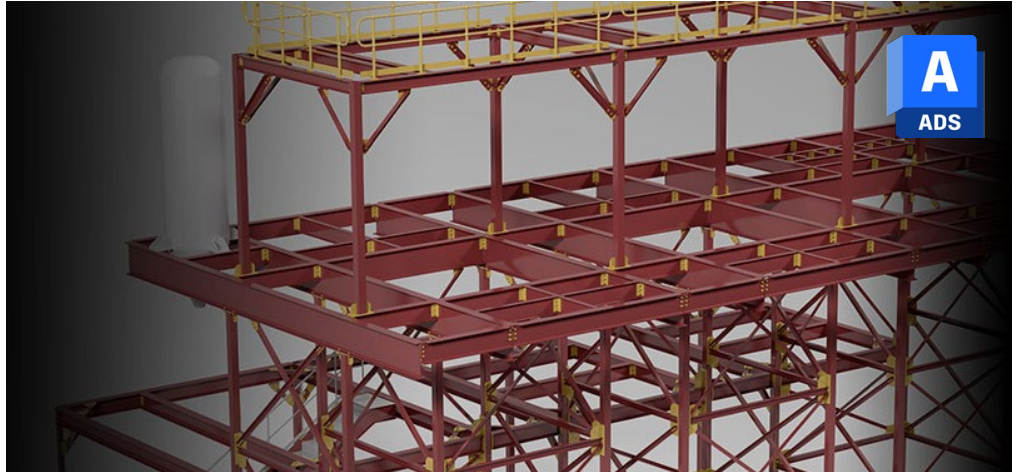

Course summary

Teaches the key functionality, tools, commands and workflows used in Advance Steel to create and detail steelwork.

By building a steel structure from the ground up, you'll learn to create:

- Beams and columns.
- Plates.
- Connection elements.
- Lists and schedules, such as Bills of Materials and loading lists.
- Drawings.

Duration

Two days.

Who should attend?

New users of Advance Steel.

Prerequisites

You should have good general CAD skills, i.e. have attended [AutoCAD Essentials training](#) or have equivalent knowledge.

In-class or live online

You can attend course in-person at our centres, or participate online from your place of work or home.

To read about our approach to online training, see [armada.co.uk/live-online-training](#).

Advance Steel Essentials training is available as a scheduled (public) course, or on-request, i.e. one-to-one or a 'closed course' for your group.

General information

Armada is an Autodesk authorised Training Centre (ATC), accredited to provide training in Advance Steel.

Courses are hosted by Autodesk Certified Instructors (ACIs) with vast experience of using the application.

Whilst attending training at our centres, delegates have the use of a computer running Advance Steel to practice the techniques taught. Course fees can be paid by card or bank transfer. We accept purchase orders from UK-registered companies and public sector organisations.

If you're self-funding your training, you can pay in staged payments, interest-free, over 12 months.

Course materials and certificate

Delegates receive:

- Comprehensive training materials.
- An e-certificate from Autodesk confirming successful completion of an accredited *Advance Steel Essentials* course.

After course support

Following Advance Steel training, you're entitled to 30 days' email support from your trainer.

Further information, prices & dates

See: [armada.co.uk/course/advsteel](#).

Course syllabus

See over.

Follow-on course

Advance Steel Advanced (2 days). See [armada.co.uk/course/advsteeladv](#) for details.

Course syllabus

Session	Topics
Getting Started with Advance Steel	The basics – beams, plates, connections and structures The Advance Steel user interface Ribbon tabs Advance Steel tools Advance Steel palettes The file and folder structure Grids The User Coordinate System (UCS)
Viewing Tools	Changing viewpoints and visual styles Navigating through the model Use of layers
Beams and columns	Beam features Drawing beams individually and using macros Cutting and shaping beams Notch contours

Session	Topics
Plates	Creating plates of all types and shapes Cutting and shaping plates Flat plates Folded plates Chamfers
Connection elements	Bolts Holes Welds
Lists	Bills of Materials (BOMs) Bolt schedules Loading list
Drawings	Locating points in the Drawing Window Generation Parts Assemblies Manipulation